



# COMPLEMENTARY PROFESSIONNANL TOOLS



2019/1

## **EXPORT EUROPE & USA**

General	+32 (0)2 648 35 17
Accounting	+32 (0)2 626 02 16
Fax	+32 (0)2 648 65 95
Informations	<a href="mailto:info@casteels.fr">info@casteels.fr</a>
Orders	<a href="mailto:orders@casteels.fr">orders@casteels.fr</a>



<b>Alphabetical index</b>	<b>3</b>
<b>Ratchets</b>	<b>4</b>
72 Teeth swivel head ratchet	4
90 Teeth adjustable ratchet	4
Waterproof 90 teeth ratchet	4
Adjustable ratchet wrenches 1/2"	5
Adjustable ratchet wrench 3/4"	5
Digital dynamometric adapter	6
<b>Key sets</b>	<b>7</b>
Set of 6 ratchet pipe wrenches	7
Set of 4 self adjusting wrenches	7
Adjustable ratchet spanner wrench	7
Set of HEX wrenches   with extractor	8
Set of HEX wrenches   short profile tip	8
Set of STAR/TORX wrenches   Tamperproof	8
Compact wrench sets	8
Set of "Turbo-Z" wrenches	9
Set of "FLEX" wrenches	9
Tube wrench for one hand (ratchet effect)	9
<b>Sockets &amp; bits</b>	<b>10</b>
Sets of extensions	10
Set of locking cardans	10
Bit holder 90°	10
Flexible magnetic bit holder	11
Expandable bit holder	11
Magnetic bit holder	11
Cardan bit holder (30°)	12
Magnetic bits	12
Mini ratchet screwdriver with bits	12
Extra-long screwdriver	12
T-handle	13
Set of sockets and bits + mini-ratchet	13
Set of hexagonal drill bits	13
<b>Impact sockets &amp; bits</b>	<b>14</b>
Shock bits PH2	14
Shock bits PZ2	14
Shock extensions	14
Shock extension with Turbo sleeve	14
Set of 11 extraction sockets	15
Set of 4 long extraction sockets	15
Set of shock socket adapters	15
Set of socket adapters	15
Socket holders	16
Magnetic impact adapters	16
Sets of articulated shock sockets	16
Set of STAR (TORX) shock sockets with swivel joint 1/4" & 1/2"	17
Set of HEX shock sockets with swivel joint 1/4" & 1/2"	17
Set of SPLINE shock sockets with swivel joint 1/4" & 1/2"	17
Set of STAR (TORX) shock sockets 1/4" & 1/2"	18
Set of HEX shock sockets 1/4" & 1/2"	18
Set of SPLINE shock sockets 1/4" & 1/2"	18

<b>Compressed air pistols &amp; blowguns</b>	<b>19</b>
Mini air gun with rubber tip	19
"Turbo" air gun	19
Sliding extensible air gun	19
Air gun with interchangeable blowguns	20
Cleaning gun	20
Refillable eco aerosol	20
<b>Striking tools</b>	<b>21</b>
Interchangeable chisels and drift punches	21
Striking screwdriver 1/2"	21
Striking chisels	21
Heavy Duty striking chisel	22
Multifunctional striking scraper	22
<b>Power tools</b>	<b>23</b>
Lever with adjustable head 600mm	23
Expandable lever with adjustable head 450-750mm	23
Set of 3 levers met adjustable head and ratchet effect	24
Adjustable crowbar with nail extractor	24
<b>Miscellaneous tools</b>	<b>25</b>
Extractors for damaged screws	25
External deburring tool 8-22mm	25
Very flat folding hand truck	25
Retractable magnetic cone	26
Universal funnel with clamp	26
Adjustable gasket extractor	26
Set of 4 joint extractors	26
Set of 4 hooks with LED magnifier	27
Magnifying glass x2 with LED lamp	27
Magnifying glass x3 with LED lamp	27
Telescopic LED inspection lamp	28
Magnetic ultra-powerful LED lamp	28
Rechargeable LED safety lights	28
Contactless voltage detector	29
Hydraulic brake fluid tester	29
Foldable cross wrench	29
Storage case	29
Multifunctional clamp 5-in-1	30
Retractable ceramic cutter	30
Scraper with retractable razor blade	30
Scraper with interchangeable plastic blade	31
Engraver with diamond head	31
Anti-slip bodywork cover	31
Protection carpet with LED lights	31
Universal battery holder	32
Terminal and battery terminal cleaner	32
<b>Tool sets</b>	<b>33</b>
Professional tool box 160 pcs	33
Motorbike tool kits	34
Essential motorbike tool kit (54 pcs)	35
Basic motorbike set (60 pieces) and extension sleeve	35
Motorbike set specific for BMW (70 pieces)	36
Motorbike set specific for KTM & Ducati (68 pieces)	36

Motorbike set specific for Triumph, Honda, Kawasaki, Suzuki & Yamaha (70 pièces)	37
Very complete motorbike tool set (all brands)(75 pieces)	37
<b>Displays</b>	<b>38</b>
Support for mini-displays	38
Metallic displays	38
<b>Part numbers index</b>	<b>39</b>

7	
72 Teeth swivel head ratchet .....	4
9	
90 Teeth adjustable ratchet .....	4
A	
Adjustable crowbar with nail extractor .....	24
Adjustable gasket extractor .....	26
Adjustable ratchet spanner wrench .....	7
Adjustable ratchet wrench 3/4" .....	5
Adjustable ratchet wrenches 1/2" .....	5
Air gun with interchangeable blowguns .....	20
Anti-slip bodywork cover .....	31
B	
Basic motorbike set (60 pieces) and extension sleeve .....	35
Bit holder 90° .....	10
C	
Cardan bit holder (30°) .....	12
Cleaning gun .....	20
Compact wrench sets .....	8
Contactless voltage detector .....	29
D	
Digital dynamometric adapter .....	6
E	
Engraver with diamond head .....	31
Essential motorbike tool kit (54 pcs) .....	35
Expandable bit holder .....	11
Expandable lever with adjustable head 450-750mm .....	23
External deburring tool 8-22mm .....	25
Extractors for damaged screws .....	25
Extra-long screwdriver .....	12
F	
Flexible magnetic bit holder .....	11
Foldable cross wrench .....	29
H	
Heavy Duty striking chisel .....	22
Hydraulic brake fluid tester .....	29
I	
Interchangeable chisels and drift punches .....	21
L	
Lever with adjustable head 600mm .....	23
M	
Magnetic bit holder .....	11
Magnetic bits .....	12
Magnetic impact adapters .....	16
Magnetic ultra-powerful LED lamp .....	28
Magnifying glass x2 with LED lamp .....	27
Magnifying glass x3 with LED lamp .....	27
Metallic displays .....	38
Mini air gun with rubber tip .....	19
Mini ratchet screwdriver with bits .....	12
Motorbike set specific for BMW (70 pieces) .....	36
Motorbike set specific for KTM & Ducati (68 pieces) .....	36
Motorbike set specific for Triumph, Honda, Kawasaki, Suzuki .....	37
Motorbike tool kits .....	34
Multifunctional clamp 5-in-1 .....	30
Multifunctional striking scraper .....	22
P	
Professional tool box 160 pcs .....	33
Protection carpet with LED lights .....	31
R	
Rechargeable LED safety lights .....	28
Refillable eco aerosol .....	20
Retractable ceramic cutter .....	30
Retractable magnetic cone .....	26
S	
Scraper with interchangeable plastic blade .....	31
Scraper with retractable razor blade .....	30
Set of "FLEX" wrenches .....	9
Set of "Turbo-Z" wrenches .....	9
Set of 11 extraction sockets .....	15
Set of 3 levers met adjustable head and ratchet effect .....	24
Set of 4 hooks with LED magnifier .....	27
Set of 4 joint extractors .....	26
Set of 4 long extraction sockets .....	15
Set of 4 self adjusting wrenches .....	7
Set of 6 ratchet pipe wrenches .....	7
S	
Set of HEX shock sockets 1/4" & 1/2" .....	18
Set of HEX shock sockets with swivel joint 1/4" & 1/2" .....	17
Set of HEX wrenches   short profile tip .....	8
Set of HEX wrenches   with extractor .....	8
Set of hexagonal drill bits .....	13
Set of locking cardans .....	10
Set of shock socket adapters .....	15
Set of socket adapters .....	15
Set of sockets and bits + mini-ratchet .....	13
Set of SPLINE shock sockets 1/4" & 1/2" .....	18
Set of SPLINE shock sockets with swivel joint 1/4" & 1/2" .....	17
Set of STAR (TORX) shock sockets 1/4" & 1/2" .....	18
Set of STAR (TORX) shock sockets with swivel joint 1/4" & 1/ .....	17
Set of STAR/TORX wrenches   Tamperproof .....	8
Sets of articulated shock sockets .....	16
Sets of extensions .....	10
Shock bits PH2 .....	14
Shock bits PZ2 .....	14
Shock extension with Turbo sleeve .....	14
Shock extensions .....	14
Sliding extensible air gun .....	19
Socket holders .....	16
Storage case .....	29
Striking chisels .....	21
Striking screwdriver 1/2" .....	21
Support for mini-displays .....	38
T	
"Turbo" air gun .....	19
Telescopic LED inspection lamp .....	28
Terminal and battery terminal cleaner .....	32
T-handle .....	13
Tube wrench for one hand (ratchet effect) .....	9
U	
Universal battery holder .....	32
Universal funnel with clamp .....	26
V	
Very complete motorbike tool set (all brands)(75 pieces) .....	37
Very flat folding hand truck .....	25
W	
Waterproof 90 teeth ratchet .....	4



72 TEETH SWIVEL HEAD RATCHET



Ratchet wrench with adjustable head of 270°.  
With T-bar.  
Push button to extract the socket.  
Useful in narrow spaces to remove little fixations.

Part number	Description	Material	
Per unit, with hanging tag			
BV.11HT002	Ratchet with adjustable head 1/4"	CRV	1

90 TEETH ADJUSTABLE RATCHET



The ratchet with 90 teeth enables to work in an angle of only 4°, and giving acces to narrow spaces.  
Comfortable aluminium handle.  
Adjustable head of 270°.  
Push button to extract the socket.



Part number	Description	
Packed in a mini-display		
BV.52190	90 Teeth ratchet 1/4" (170mm)	6
Per unit, with hanging tag		
BV.52191	90 Teeth ratchet 1/2" (320mm)	1

Part number	Description	
Bulk		
BV.52277	Replacement head 1/4"	1
BV.52278	Replacement head 1/2"	1

WATERPROOF 90 TEETH RATCHET



The flat head enables to work in narrow spaces.  
Comfortable aluminium handle.





Part number	Description	
Packed in a mini-display		
BV.52188	Waterproof ratchet 1/4" (150mm)	6
Per unit, with hanging tag		
BV.52189	Waterproof ratchet 1/2" (413mm)	1

ADJUSTABLE RATCHET WRENCHES 1/2"



Ratchet wrench with adjustable head of 180°. 3 position ratchet action: right, left or locked. Heavy duty arm to increase working power. Matte chrome satin finish for better corrosion protection.





Part number	Description	Material	
Per unit, with hanging tag			
BV.52056	Adjustable ratchet wrench 1/2" (450mm)	CRV	1
BV.52057	Adjustable ratchet wrench 1/2" (600mm)	CRV	1
Part number	Description		
Bulk			
BV.52176	Ratchet head 1/2"		1

ADJUSTABLE RATCHET WRENCH 3/4"



Ratchet wrench with 180° adjustable Cr-Mo head (Heavy Duty). 3 position ratchet action: right, left or locked. Heavy duty arm to increase working power. Matte chrome satin finish for better corrosion protection.



Part number	Description	Material	
Per unit, with hanging tag			
BV.52193	Adjustable ratchet wrench 3/4" (730mm)	CRV	1
Part number	Description		
Bulk			
BV.52202	Ratchet head 3/4"		1

DIGITAL DYNAMOMETRIC ADAPTER

Rated torque: 5Nm - 203Nm



Converts your ratchet into a torque wrench.  
LED back light.  
Preset torque value.



Part number	Description	
Packed in case		
BV.52295	Dynamometric adapter 3/8" > 3/8" + 3/8" > 1/4"	1
BV.52142	Dynamometric adapter 1/2" > 1/2"	1



SET OF 6 RATCHET PIPE WRENCHES

6x12 sides



Wrenches in Chrome-Vanadium: long service life.  
Satin chome finish for a perfect grip.  
12-sided reversible pawl allowing a fast approach with a better recovery angle.  
6 side unblocked sockets.



Part number	Description	
Packed in box, with hanging notch		
BV.52172	Set of 6 ratchet pipe wrenches Sizes: 10, 11, 12, 13, 16 & 17mm	1

SET OF 4 SELF ADJUSTING WRENCHES

9 to 20mm



Sizes MM: 9, 10, 11, 12, 13, 14, 15, 16, 17, 18, 19 & 20  
Sizes SAE: 11/32, 3/8, 7/16, 15/32, 1/2, 9/16, 19/32, 5/8, 11/16, 23/32, 3/4 & 25/32  
Chrome-Vanadium: longer service life.  
Self adjusting jaw.  
Ratchet effect.



Part number	Description	
Packed in case		
BV.52203	Set of 4 self adjusting wrenches 9 to 20mm	1

ADJUSTABLE RATCHET SPANNER WRENCH

Pratical & innovative spanner wrench



ON/OFF button upon the ratchet allows to use the tool in two ways, ratchet or wrench.  
The mobile jaw is effective for all fixations of 4 or 6 points.  
A higher torque and a light arm.

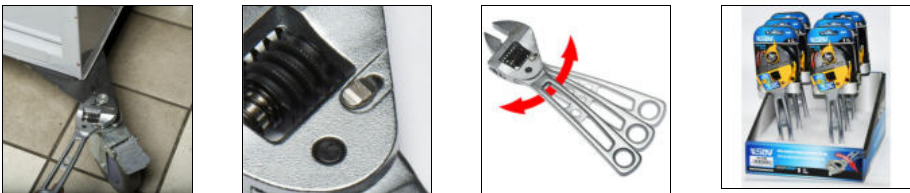

Part number	Description	
Packed in a mini-display		
BV.52145	Spanner wrench with maximum opening of 26mm - L: 210mm	9
BV.52192	Spanner wrench with maximum opening of 35mm - L: 250mm	9

## SET OF HEX WRENCHES | WITH EXTRACTOR



To remove damaged HEX nuts.  
The sharp patented teeth are designed to bite in the material and in this way to remove nuts without producing other damages.  
The rounded tip on the large end allows up to 25° of entry angle for use in hard-to-reach areas.  
Chrome finish against corrosion.



Part number	Description	Material	
Packed in blister			
<b>BV.52031</b>	HEX BALL: 1.5, 2, 2.5, 3, 4, 5, 6, 8, 10 mm	S2 steel	1

## SET OF HEX WRENCHES | SHORT PROFILE TIP



Short profile tip for a better acces in narrow spaces.  
Chrome finish against corrosion.

Part number	Description	Material	
Packed in blister			
<b>BV.52032</b>	HEX: 1.5, 2, 2.5, 3, 4, 5, 6, 8, 10 mm	S2 steel	1

## SET OF STAR/TORX WRENCHES | TAMPERPROOF

Extra long



Wrenches with drilled nozzle to use it on security STAR/TORX fixations.  
Chromed finish to be corrosion resistant.  
Easy to read sizes thanks to laser engraved marking.



Part number	Description	Material	
Packed in blister			
<b>BV.52030</b>	STAR (TORX): T10, T15, T20, T25, T27, T30, T40, T45, T50	S2 steel	1

## COMPACT WRENCH SETS



The most compact with all sizes.  
Ultra resistant bits in S2 steel.



Part number	Description	Material	
Packed in a mini-display			
<b>BV.52130</b>	 STAR (TORX): T6, T7, T8, T9, T10, T15, T20, T25, T27, T30 The hozzels are drilled to use it in a more secured way on the fixations	S2 steel	8
<b>BV.52131</b>	 HEX BALL: 1.5, 2, 2.5, 3, 4, 5, 6mm, PH2 Flat: 6mm	S2 steel	8

## SET OF "TURBO-Z" WRENCHES



Designed with a double swivel joint allow to reach confined and narrow spaces.  
This design allows the tool to be positioned in a Z-shape.  
This configuration allows quick screwing and unscrewing.  
The rotating handle offers comfortable working in all positions.  
Ideal tool for all pieces that requests speed and for small spaces.

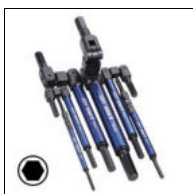

Part number	Description	Material	
Per unit, with hanging tag			
<b>BV.52016</b>	HEX: 3, 4, 5, 6, 8, 10mm	CRV 6150	1
<b>BV.52017</b>	STAR (TORX): T20, T25, T27, T30, T40, T45, T50	CRV 6150	1
<b>BV.52044</b>	SPLINE (XZN): M4, M5, M6, M8, M10	CRV 6150	1

## SET OF "FLEX" WRENCHES



180° Pivotal head to rotate easily around obstacles.  
Extra long handle to reach difficult accessible spaces.  
Black finish with anti-slip paint.

Part number	Description	Material	
Per unit, with hanging tag			
<b>BV.52045</b>	HEX: 3, 4, 5, 6, 7, 8, 10mm	CRV 6150	1
<b>BV.52046</b>	STAR (TORX): T20, T25, T27, T30, T40, T45, T50	CRV 6150	1

## TUBE WRENCH FOR ONE HAND (RATCHET EFFECT)

Innovative tube wrenches to use with one hand



Can be placed, clamped and removed using only one hand.  
Automatically adjusting to the tube size.  
3 very powerful clamping points: the clamping increase with the applied couple.



Part number	Description	Material	
Per unit, with hanging tag			
<b>BV.52162</b>	Tube wrench 10" (250mm) Opening 17-33mm	Steel	1
<b>BV.52163</b>	Tube wrench 12" (300mm) Opening 21-42mm	Aluminium	1
<b>BV.52164</b>	Tube wrench 14" (350mm) Opening 21-48mm	Aluminium	1
<b>BV.52165</b>	Tube wrench 18" (450mm) Opening 33-60mm	Aluminium	1

## SETS OF EXTENSIONS

**POPLOCK®**

POPLOCK® patented locking technology



With POPLOCK® mechanism: automatic locking & manual unlocking of the socket.

This concept allows the user to lock the socket in a secure way when working and in this way to avoid that the socket falls.

Pour dans des zones restreintes, étroites et profondes.

All our extension cords have a hexagonal head that allows them to be used with a flat wrench in situations where the ratchet is too bulky.

Part number	Description	Material	
Per unit, with hanging tag			
<b>BV.52027</b>	Set of 3 POPLOCK® extensions - 1/4" 150, 300 & 450mm	CRV	1
<b>BV.52028</b>	Set of 3 POPLOCK® extensions - 3/8" 250, 450 & 600mm	CRV	1
<b>BV.52029</b>	Set of 3 POPLOCK® extensions - 1/2" 250, 450 & 600mm	CRV	1

## SET OF LOCKING CARDANS

**POPLOCK®**

POPLOCK® patented locking technology



With POPLOCK® mechanism: automatic locking & manual unlocking of the socket.

This concept allows the user to lock the socket in a secure way when working and in this way to avoid that the socket falls.

For restricted, narrow and deep areas.

Include:

1/4 "(F) x 1/4" (M), 3/8 "(F) x 3/8" (M), 1/2 "(F) x 1/2" (M)



Part number	Description	Material	
Packed in box, with hanging notch			
<b>BV.52025</b>	Set of 3 POPLOCK® cardans	CRV	1

## BIT HOLDER 90°

With 360° swivel handle.



The bit holder allows to remove easily screws which are placed in difficult angles. Powerful magnet.



Part number	Description	
Packed in a mini-display		
<b>BV.52039</b>	Bit holder 90° 1/4"	8



## FLEXIBLE MAGNETIC BIT HOLDER

1/4" HEX



The flexible bit holder allows the user to reach screws in confined and inaccessible spaces.  
Quick lock, magnetic tip, sliding sleeve.  
A powerful magnet guarantees proper stability of the screw on the tip holder.  
The outer sleeve does not rotate in order to direct it.

Part number	Description	
Packed in blister		
BV.52037	Magnetic & flexible bit holder 1/4" (330mm)	1



## EXPANDABLE BIT HOLDER

With magnetic support



The mobile external handle allows the user to stabilise the extension for a precise screwing and unscrewing.  
1/4" hexagonal rod with magnetic lock.  
A powerful magnet guarantees good stability of the bit.

Part number	Description	
Packed in blister		
BV.52054	Extension bit-holder 1/4" (490mm)	1

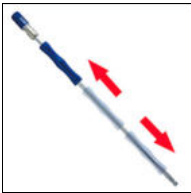
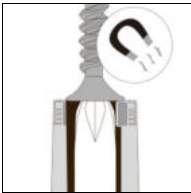

## MAGNETIC BIT HOLDER

With 7 bits



12 times stronger than the standard magnetic bit holder.  
Maximum speed: 3000 revs/min.  
Flange rotation for better control.  
Easy to operate with one hand.  
Sizes: PH: 1, 2, 3; PZ: 1, 2; SL: 6-8, 8-10

Part number	Description	
Packed in blister		
BV.52038	Magnetic bit holder	1



## CARDAN BIT HOLDER (30°)

With adjustable head



The adjustable head of 30° allows the user to reach difficult accessible spaces.  
1/4" hexagonal rod locking in straight position.  
Quick locking and unlocking. (Single pressure)  
Powerful magnet.



Part number	Description	
Packed in blister		
<b>BV.52052</b>	Adjustable bit holder 30° 1/4" (140mm)	1

## MAGNETIC BITS



The powerful magnet supports the screw on the holder and which allows the user to work with one hand.

Part number	Description	Material	
Packed in blister			
<b>BV.52040</b>	2x PH2 magnetic bits 1/4"	S2 steel	1
<b>BV.52051</b>	2x PZ2 magnetic bits 1/4"	S2 steel	1

## MINI RATCHET SCREWDRIVER WITH BITS



Storing the bits in the handle.  
8-bit charger: H3, H4, H5, H6, PH2, PH1, 5.5 mm, 6.5 mm.  
3-position quick release system.  
Ideal for confined spaces.



Part number	Description	
Packed in a mini-display		
<b>BV.11HA005</b>	Mini ratchet screwdriver 1/4"	9

## EXTRA-LONG SCREWDRIVER

Length 570mm



Strength, comfortable grip and durable performance.  
Extremely robust blades with black imprint.

Part number	Description	Material	
Per unit, with hanging tag			
<b>BV.52235</b>	Extra long screwdriver PH2	CRV	1
<b>BV.52236</b>	Extra long screwdriver PH3	CRV	1
<b>BV.52237</b>	Extra long screwdriver 8mm	CRV	1

## T-HANDLE

With a rotating sleeve



Long rod for a long reach in narrow spaces.  
The handle allows to apply a steady and uniform pressure, this prevents damage to the screws or nuts to be unlocked.

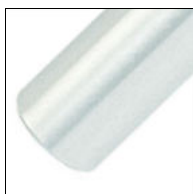
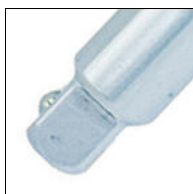

Part number	Description	Material	
Per unit, with hanging tag			
<b>BV.52100</b>	T-handle - 254mm - 1/4"	CRV	1
<b>BV.52101</b>	T-handle with magnetic bit holder - 254mm - 1/4"	CRV	1

## SET OF SOCKETS AND BITS + MINI-RATCHET

40 pcs



**Ratchet "Micro Flex" 1/4"**

**Bits (30 pcs)**

PH: 1, 2, 2, 3

SL: 4.5, 5.5, 6.5

SQ: 1, 2

HEX: 3, 4, 5, 6

STAR (TORX): T10, T15, T20, T25, T27, T30, T40

STAR (TORX) tamperproof: TT10, TT15, TT25, TT27, TT30, TT40

PZ: 1, 2, 3

**Sockets (7 pcs):**

HEX: 6, 7, 8, 10, 11, 12, 13mm

**Divers adapters & extension**



Part number	Description	Material	
Packed in blister			
<b>BV.52033</b>	Box of bits and sockets + mini ratchet 1/4"	S2 / CRV	1

## SET OF HEXAGONAL DRILL BITS



Drills in steel for drilling in steel, plastic and wood.

Thanks to the hexagonal support, the drill bit can be used with a bit holder or directly in a drilling machine.

**HEX: 1.5, 2, 2.5, 3, 4 mm**

Part number	Description	Material	
Packed in case			
<b>BV.52053</b>	Set of hexagonal drill bits 1/4"	HCC	1

## SHOCK BITS PH2

With torsion zone

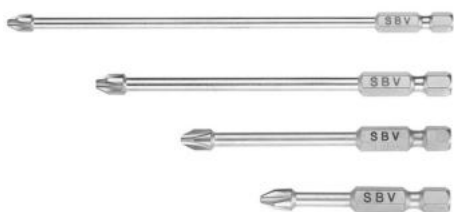

The bit has a unique design that propagates over the entire tip, the force usually exerted on the top of the tip.  
This design highly reduces the risk of breaking.

Part number	Description	
Packed in blister		
<b>BV.52126</b>	2 impact bits PH2 (50mm)	1
<b>BV.52127</b>	2 impact bits PH2 (75mm)	1
<b>BV.52128</b>	2 impact bits PH2 (100mm)	1
<b>BV.52129</b>	2 impact bits PH2 (150mm)	1

## SHOCK BITS PZ2

With torsion zone



The bit has a unique design that propagates over the entire tip, the force usually exerted on the top of the tip.  
This design highly reduces the risk of breaking.

Part number	Description	
Packed in blister		
<b>BV.52231</b>	2 impact bits PZ2 (50mm)	1
<b>BV.52232</b>	2 impact bits PZ2 (75mm)	1
<b>BV.52233</b>	2 impact bits PZ2 (100mm)	1
<b>BV.52234</b>	2 impact bits PZ2 (150mm)	1

## SHOCK EXTENSIONS

POPLOCK® patented locking technology

**POPLOCK®**



With POPLOCK® mechanism: automatic locking & manual unlocking of the socket.  
This concept allows the user to lock the socket in a secure way when working and in this way to avoid that the socket falls.  
For restricted, narrow and deep areas.

Part number	Description	Material	
Per unit, with hanging tag			
<b>BV.52138</b>	POPLOCK® shock extension - 1/2" - 125mm	Cr-Mo	1
<b>BV.52139</b>	POPLOCK® shock extension - 1/2" - 250mm	Cr-Mo	1

## SHOCK EXTENSION WITH TURBO SLEEVE



An shock extension with an additional handle to hold heavy machines safely and with less effort.  
Only the inside of the extension turns, the handle can be held firmly for an unequaled working comfort.  
Material: Steel Cr-Mo

Part number	Description	Material	
Bulk			
<b>BV.52102</b>	Extension - 1/2" - 200mm	Cr-Mo	1
<b>BV.52103</b>	Extension - 3/4" - 250mm	Cr-Mo	1
<b>BV.52104</b>	Extension - 1" - 250mm	Cr-Mo	1

## SET OF 11 EXTRACTION SOCKETS

POPLOCK® patented locking technology



With POPLOCK® mechanism: automatic locking & manual unlocking of the socket.  
This concept allows the user to lock the socket in a secure way when working and in this way to avoid that the socket falls.  
The blade edges have been developed to bite the metal optimally to remove damaged, broken or rusty nuts, bolts and screws.  
Sizes: 8, 10, 11, 12, 13, 14, 15, 16, 17, 18, 19 mm

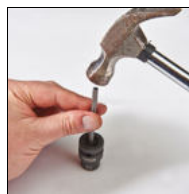

Part number	Description	Material	
Packed in case			
<b>BV.52184</b>	Socket extractors 1/2"	Cr-Mo	1

## SET OF 4 LONG EXTRACTION SOCKETS



The blade edges have been developed to bite the metal optimally to remove damaged, broken or rusty nuts, bolts and screws.  
Sizes: 17, 19, 21, 22 mm



Part number	Description	Material	
Packed in case			
<b>BV.52185</b>	Set of socket extractors 1/2"	Cr-Mo	1

## SET OF SHOCK SOCKET ADAPTERS

POPLOCK® patented locking technology



With POPLOCK® mechanism: automatic locking & manual unlocking of the socket.  
This concept allows the user to lock the socket in a secure way when working and in this way to avoid that the socket falls.  
Allows to work with an impact device.

Part number	Description	Material	
Packed in blister			
<b>BV.52055</b>	3 POPLOCK® socket adapters 1/2", 3/8", 1/4" (150mm)	CRV	1

## SET OF SOCKET ADAPTERS



Part number	Description	
Packed in blister		
<b>BV.52406</b>	3 adapters: 1/2", 3/8", 1/4"	1

**POPLOCK®**

## SOCKET HOLDERS

**POPLOCK®**

POPLOCK® patented locking technology



With POPLOCK® mechanism: automatic locking & manual unlocking of the socket.  
This concept allows the user to lock the socket in a secure way when working and in this way to avoid that the socket falls.  
It allows to use it with an impact device



Part number	Description	
Packed in blister		
<b>BV.52182</b>	POPLOCK® socket holder - 1/4" x 1/4" - 75mm	1
<b>BV.52183</b>	POPLOCK® socket holder - 1/4" x 1/2" - 75mm	1

## MAGNETIC IMPACT ADAPTERS

Shock-resistant enlarger.  
Powerful magnet that maintains the socket.  
For hand and shock use.



Part number	Description	
Packed in blister		
<b>BV.52405</b>	1/4"F x 3/8"M, 3/8"F x 1/2"M, 1/2"F x 3/4"M	1
<b>BV.52412</b>	3/4"F x 1" M	1

## SETS OF ARTICULATED SHOCK SOCKETS

Articulated technology without pin



Torsion design, absorbs impact power on the socket, in this way it is protecting the piece.  
Socket without pin is 30° orientable.



Part number	Description	
Packed in box		
<b>BV.52023</b>	Set of 3 sockets: 1/4 "(F) x 1/4" (M) 3/8 "(F) x 3/8" (M) 1/2 "(F) x 1/2" (M)	1
<b>BV.52024</b>	Set of 5 sockets: 1/4 "(F) x 3/8" (M) 3/8 "(F) x 1/4" (M) 3/8 "(F) x 1/2" (M) 1/2 "(F) x 3/8" (M) 1/2 "(F) x 3/4" (M)	1



### SET OF STAR (TORX) SHOCK SOCKETS WITH SWIVEL JOINT 1/4" & 1/2"

Articulated technology without pin



Torsion design, absorbs impact power on the socket, in this way it is protecting the bit and screw.  
The socket is 30° adjustable.  
Bits is S2 steel, hexagonal boll and socket in Cr-Mo.  
1/4": T10, T15, T20, T25, T27  
1/2": T30, T40, T45, T50, T55, T60



Part number	Description	
Packed in blister		
BV.52064	Set of 11 STAR shock sockets 1/4" & 1/2"	1

### SET OF HEX SHOCK SOCKETS WITH SWIVEL JOINT 1/4" & 1/2"

Articulated technology without pin



Torsion design, absorbs impact power on the socket, in this way it is protecting the bit and screw.  
The socket is 30° adjustable.  
Bits is S2 steel, hexagonal boll and socket in Cr-Mo.  
1/4": 6, 7, 8 mm  
1/2": 10, 12, 14, 17, 18, 19 mm



Part number	Description	
Packed in blister		
BV.52065	Set of 9 HEX shock sockets 1/4" & 1/2"	1

### SET OF SPLINE SHOCK SOCKETS WITH SWIVEL JOINT 1/4" & 1/2"

Articulated technology without pin



Torsion design, absorbs impact power on the socket, in this way it is protecting the bit and screw.  
The socket is 30° adjustable.  
Bits is S2 steel, hexagonal boll and socket in Cr-Mo.  
1/4": M5, M6  
1/2": M8, M10, M12, M14, M16, M18



Part number	Description	
Packed in blister		
BV.52066	Set of 8 SPLINE shock sockets 1/4" & 1/2"	1

SET OF STAR (TORX) SHOCK SOCKETS 1/4" & 1/2"



Torsion design, it absorbs the force on the socket, in this way it is not dammaging the socket.  
New multi material patented design with locking socket, decrease the risk of breakage.  
1/4": T20, T25  
1/2": T30, T40, T45, T50, T55, T60, T70

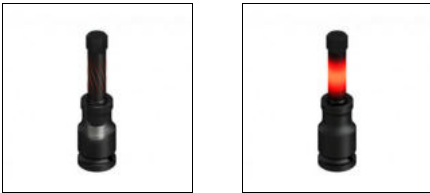

Part number	Description	
Packed in box		
BV.52134	Set of 9 STAR (TORX) shock sockets	1

SET OF HEX SHOCK SOCKETS 1/4" & 1/2"



Torsion design, it absorbs the force on the socket, in this way it is not dammaging the socket.  
New multi material patented design with locking socket, decrease the risk of breakage.  
1/4": 6 mm  
1/2": 7, 8, 10, 12, 14 mm

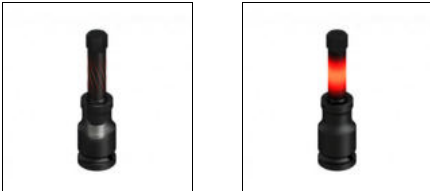

Part number	Description	
Packed in box		
BV.52136	Set of 6 HEX shock sockets	1

SET OF SPLINE SHOCK SOCKETS 1/4" & 1/2"



Torsion design, it absorbs the force on the socket, in this way it is not dammaging the socket.  
New multi material patented design with locking socket, decrease the risk of breakage.  
1/4": M4, M5, M6  
1/2": M8, M10, M12, M14

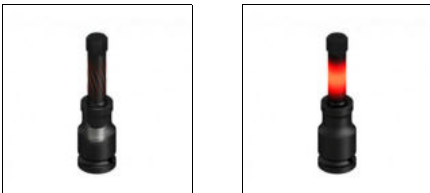

Part number	Description	
Packed in box		
BV.52132	Set of 7 SPLINE shock sockets	1

## MINI AIR GUN WITH RUBBER TIP



Protection of the cleaning surfaces (bodywork, dashboard,...)  
Soft rubber tip, for a protection of delicate surfaces.  
Ideal for professional cleaning of cars.



Part number	P	P(max)	L/min	
Packed in a mini-display				
<b>BV.52047</b>	6.2 bar	6.2 bar	104	8

## "TURBO" AIR GUN

Nozzle "Turbo Venturi": debit of air x4



Ideal to work on all vehicles in repair or body shop to dust or dry wet surfaces.  
Works as a trigger gun with non-slip surface.  
Light and practical.

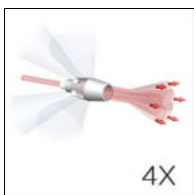

Part number	P	P(max)	L/min	
Packed in blister				
<b>BV.52049</b>	6.2 - 15.2 bar	15.2 bar	>280	1

## SLIDING EXTENSIBLE AIR GUN

350 to 610mm

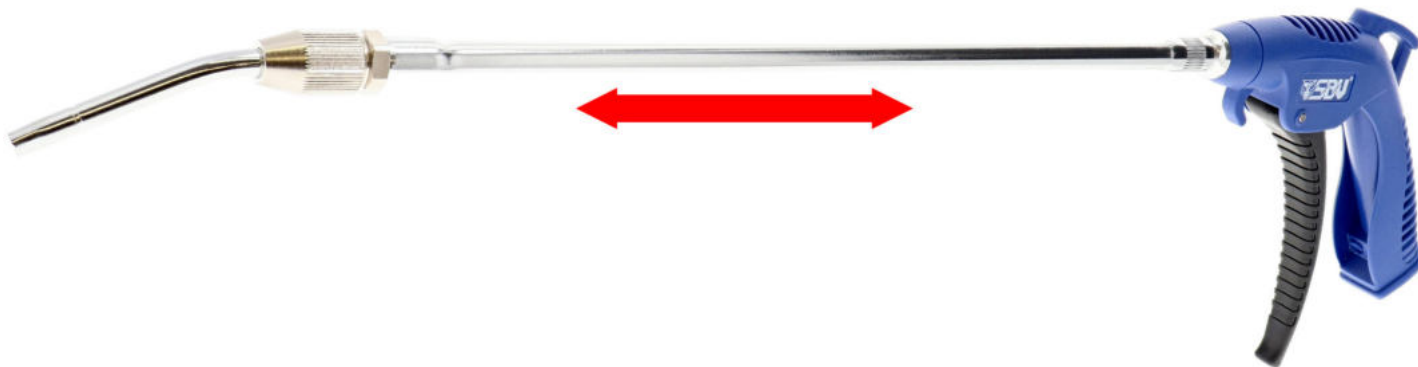

The swivel tip allows you to precisely reach the target area.  
Ideal for all kinds of vehicle radiators, civil engineering machines, heating, etc.  
Also used for pipes and hoses.

Part number	P	P(max)	L/min	
Packed in blister				
<b>BV.52050</b>	6.2 - 8.3 bar	15.2 bar	144	1

## AIR GUN WITH INTERCHANGEABLE BLOWGUNS



Blowguns: long, short, adjustable, "Turbo-Venturi"

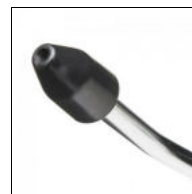

Part number	P	P(max)	L/min	
Packed in blister				
<b>BV.52296</b>	6.2 - 11.0 bar	15.0 bar	>280	1

## CLEANING GUN

Compressed air cleaner with tank for cleaning products



"Tornado" effect allows to lift and eject dirt.

Easy to use for cleaning air vents, seats, gear levers, rims, door interiors,...

Also for cleaning rims, fuel filler, corners (trunk, motor compartments) and difficult to reach spaces.



Part number	Description	
Packed in box		
<b>BV.52120</b>	Cleaning gun + tank	1

## REFILLABLE ECO AEROSOL

Capacity: 250ml



Refillable eco-aerosol with compressed air (with a compressor or a foot pump).

For oils, cleaning products, degreasers, disinfectants, deodorants, lubricants, etc.

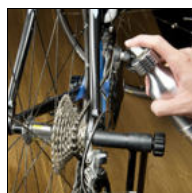

Part number	Description	
Packed in box, with hanging notch		
<b>BV.52141</b>	Refillable ECO aerosol	1

Part number	Description	
Packed in a small bag		
<b>BV.52170</b>	Repair kit (nozzle & toric joint)	1

## INTERCHANGEABLE CHISELS AND DRIFT PUNCHES

Striking handle + 12 chisels / drift punches



TPR handle with double protection.  
Automatic locking with release button for the socket.

**Content:**

- 1x Handle selflocking
- 5x Flat chisels: 13, 16, 19, 22 & 25mm
- 1x Cap chisel: 6mm
- 2x Drift punches: 3 & 6mm
- 2x Sharp drift punches: 5 & 6mm
- 2x Centre punches: 3 & 5mm



Part number	Description	
Packed in case		
<b>BV.52401</b>	Kit of chisels / drift punches	1

## STRIKING SCREWDRIVER 1/2"

Striking handle + 8 interchangeable bits



TPR handle with double protection.  
Reversible function.  
1/4 rotation with each blow of the hammer.

**Content:**

- 1x Bitholder 1/2"
- 4x Bits: PH2, PH3, flat 8 & 10mm
- 3x Bits: PH2, PH3, 8mm
- 1x Extractor bits: 80mm (M14-M18)



Part number	Description	
Packed in case		
<b>BV.52400</b>	Kit of striking screwdriver with 8 bits	1

## STRIKING CHISELS

With re-sharpening the blade



Chisels with striking head on the end of the handle.  
420-J2 Stainless steel, allows to re-sharp the blade.

Part number	Description	Material	
Per unit, with hanging tag			
<b>BV.52058</b>	Straight chisel 32mm	420-J2 steel	1
<b>BV.52059</b>	Straight chisel 75mm	420-J2 steel	1
<b>BV.52060</b>	Curved chisel 32mm	420-J2 steel	1
<b>BV.52061</b>	Curved chisel 75mm	420-J2 steel	1



## HEAVY DUTY STRIKING CHISEL

*With self-locking belt clip case*



Double security system with self-locking case.  
The end of the handle is reinforced.  
Combination of a striking chisel (26mm) and striking knife (100mm).  
Curved finger protection for use as a lever.

Part number	Description	
Per unit, with hanging tag		
<b>BV.52186</b>	Heavy Duty striking chisel	1

## MULTIFUNCTIONAL STRIKING SCRAPER

*5 functions*



420-J2 stainless steel to re-sharpen the blade.  
45° & 90° tips, blade, nail puller, painting roll cleaner, striking head.

Part number	Description	Material	
Per unit, with hanging tag			
<b>BV.52407</b>	Multifunctional striking scraper	420-J2 steel	1

LEVER WITH ADJUSTABLE HEAD 600MM



Patented technology GEARBAR®



Industrial finish in magnesium phosphate (protect againts corrosion).  
Strong equipment, for mechanics of PL, TP & AGRI.  
To extract easily pieces like injectors, joints, rollers, casings, exles, kneecaps, etc.  
Allows to align the sheet metals before welding, and the implementation of frame elements.

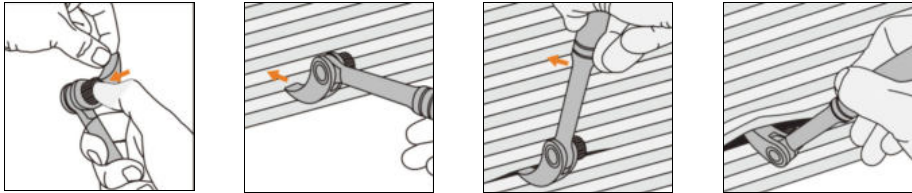

Part number	Description	
Per unit, with hanging tag		
BV.52021	GEARBAR® lever 600mm	1

EXPANDABLE LEVER WITH ADJUSTABLE HEAD 450-750MM



Patented technology GEARBAR®



Industrial finish in magnesium phosphate (protect againts corrosion).  
Strong equipment, for mechanics of PL, TP & AGRI.  
To extract easily pieces like injectors, joints, rollers, casings, exles, kneecaps, etc.  
Allows to align the sheet metals before welding, and the implementation of frame elements.

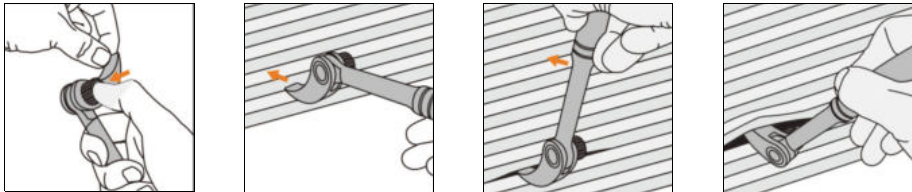

Part number	Description	
Per unit, with hanging tag		
BV.52022	GEARBAR® lever 450-750mm	1

SET OF 3 LEVERS MET ADJUSTABLE HEAD AND RATCHET EFFECT



Patented technology GEARBAR®



Industrial finish in magnesium phosphate (protect againts corrosion).  
Strong equipment, for mechanics of PL, TP & AGRI.  
To extract easily pieces like injectors, joints, rollers, casings, exles, kneecaps, etc.  
Allows to align the sheet metals before welding, and the implementation of frame elements.

Content:

- Lever 380mm with 15mm point and double joint: configurable as you wish
- Lever 300mm with 11mm point V-grooved
- Lever 225mm with 7mm point

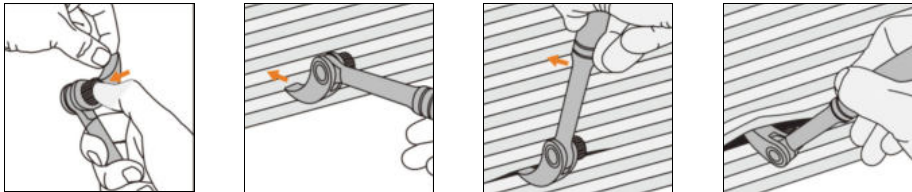

Part number	Description	
Per unit, with hanging tag		
BV.52020	Set of 3 GEARBAR® levers with ratchet	1

ADJUSTABLE CROWBAR WITH NAIL EXTRACTOR

Forged ultra-resistant CRV steel



Adjustable head by 2 buttons to position the head at the desired angle.  
Option to hit on the head with a hammer.  
Nail extractor on head and handle.



Part number	Description	
Per unit, with hanging tag		
BV.52404	Adjustable crowbar with nail extractor	1

## EXTRACTORS FOR DAMAGED SCREWS



Works on cross, flat, Allen screw heads.  
Removes broken and bent screws and bolts without damage.  
Hexagonal rod for drilling machines, sockets and screwdrivers.



Part number	Description	Material	
Packed in a mini-display			
<b>BV.52035</b>	3 screw extractors 1/4"	SUJ-2 steel	10

## EXTERNAL DEBURRING TOOL 8-22MM

UNISTAR



Chamfers and deburr: Soft & hard inox steel, brass, copper, aluminium, glass, plastic and wood.  
Appropriate for screw and threaded rod of 8-22mm.

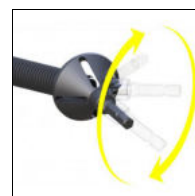
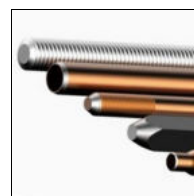
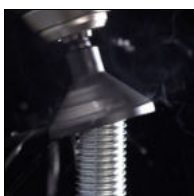

Part number	Description	Material	
Per unit, with hanging tag			
<b>BV.52409</b>	UNISTAR deburring tool 1/4"	HRC 60	1

## VERY FLAT FOLDING HAND TRUCK

Load: 125kg



Ultra-flat aluminium trolley, with a large tray for bulky loads.  
Very strong aluminum fabrication.  
Polyurethane wheels with ball bearings, puncture-proof tires 178 mm.  
Wheels and plate are easy automatically foldable.  
Handle adjustable in height by pressing button.  
Black elastic tensioner included.  
Ideal for traveling, for visiting fairs, to go to the office,...

### Dimensions:

Folded: 488x64x765mm  
Open: 488x500x1090mm  
Plate: 490x320mm



Part number	Description	Material	
Packed in box			
<b>BV.52125</b>	Folding hand truck	Aluminium	1

## RETRACTABLE MAGNETIC CONE



Height: open: 95mm / closed: 20mm  
Width: 135mm  
With powerful magnet.



Part number	Description	
Packed in a mini-display		
<b>BV.11HT001</b>	Magnetic cone	12

## UNIVERSAL FUNNEL WITH CLAMP

Auto-adjustable of 28 to 74mm

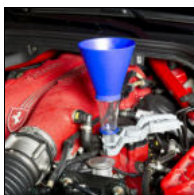

Part number	Description	
Packed in blister		
<b>BV.52123</b>	Universal funnel	1

## ADJUSTABLE GASKET EXTRACTOR



Jaws: 3mm.  
Adjustable head to remove easily seals, bearings,...  
TPR handle for reinforced grip.

Part number	Description	
Per unit, with hanging tag		
<b>BV.52402</b>	Gasket extractor	1

## SET OF 4 JOINT EXTRACTORS



The set allows to extract joints the most of the time.  
The spoons are not cutting to avoid the risk of scratches.  
Storage bag is included.  
2 curved spoons & 2 straight spoons.

Part number	Description	Material	
Packed in a pouch			
<b>BV.52098</b>	4 joint extractors	Steel	1



SET OF 4 HOOKS WITH LED MAGNIFIER



Includes 4 hooks: curved, 90°, 30° and straight.  
Exceptional for precision work.  
Super bright LED.  
Optically distortion-free quality glass and scratch and dirt resistant.



Part number	Description	Material	
Packed in blister			
BV.52099	Set of 4 hooks with LED magnifier	Stainless steel	1

MAGNIFYING GLASS X2 WITH LED LAMP

Magnification x2



Makes reading easier or seeing the details in any lighting condition.  
Optically distortion-free quality glass.  
TPR frame protection.



Part number	Description	
Packed in a mini-display		
BV.52041	Magnifying glass x2 with LED lamp	9

MAGNIFYING GLASS X3 WITH LED LAMP

Magnification x3



Makes reading easier or seeing the details in any lighting condition.  
Optically distortion-free quality glass.  
TPR frame protection.



Part number	Description	
Packed in a mini-display		
BV.52410	Magnifying glass x3 with LED lamp	9

## TELESCOPIC LED INSPECTION LAMP

With inspection mirror 360°



Telescopic and flexible up to 530mm to reach small spaces.  
The inspection mirror turns 360°.  
Powerful magnet with a light to extract objects up to 2kg.  
3 super luminous LED light with practical switch.

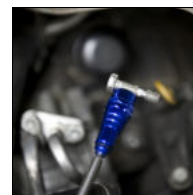

Part number	Description	
Packed in a mini-display		
<b>BV.52140</b>	LED telescopic light	9

## MAGNETIC ULTRA-POWERFUL LED LAMP

Ultra-powerful, flexible, magnetic and rechargeable lamp.  
Adjustable brightness up to 10,000 lux (50cm).  
Rotate 360°.  
Different levels of lumosity.







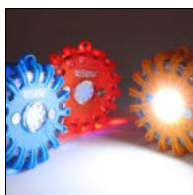

Part number	Description	
Packed in box		
<b>BV.52423</b>	Ultra-powerful LED light	1

## RECHARGEABLE LED SAFETY LIGHTS



9 lighting options with an autonomy of 6 to 45h.  
Rechargeable battery.  
For all emergency situations, this lamp sends a powerful light out of 360° with 16 LEDs.  
Visible up to 1,5km.  
With magnet to hang on vehicles.



Part number	Description	
Packed in blister		
<b>BV.52121</b>	 Security LED light	1
Packed in box		
<b>BV.52168</b>	 Security LED light	1
<b>BV.52169</b>	 Security LED light	1
<b>BV.52279</b>	 Security LED light	1
Packed in case		
<b>BV.52303</b>	 Case with 2 security LED lights and 3 different chargers	1
<b>BV.52304</b>	 Case with 2 security LED lights and 3 different chargers	1

## CONTACTLESS VOLTAGE DETECTOR



Locate electrical losses on electric cables under tension.  
Thanks to the sensibility adjustment, this tool allows to detect cables behind walls or around switches, in a secured way.  
Audio & indicator LED signal.  
Test: 12 to 600 V AC  
2 batteries included: LR44 1,5V



Part number	Description	Material	
Packed in a mini-display			
<b>BV.52166</b>	Voltage detector (150mm)	ABS	8

## HYDRAULIC BRAKE FLUID TESTER



Determines quickly the humidity in the hydraulic brake fluid.  
Battery included: 1x AAA 1,5V



Part number	Description	
Packed in a mini-display		
<b>BV.52167</b>	Hydraulic brake fluid tester	8

## FOLDABLE CROSS WRENCH



Easy to store.  
Sliding seal for enhanced leverage effect and space-saving.  
Sizes: 17, 19, 21, 1/2"



Part number	Description	
Packed in box, with hanging notch		
<b>BV.52403</b>	Foldable cross wrench (40cm)	1

## STORAGE CASE



Foam: 35mm  
Closing in stainless steel



Part number	Description	Material	
Bulk			
<b>BV.52097</b>	Storage case (435x355x80mm)	PEHD	1

## MULTIFUNCTIONAL CLAMP 5-IN-1



Ergonomic design of the handle to reach small spaces.  
Ideal clamp for crimping, stripping, cutting and remove.

**Functions:**

- Long clamp 89mm
- Bolt extractor
- Stripping clamp with stripping holes (0,6-2,6mm)
- Cable cut clamp
- Clamp for crimping the ends of the cable

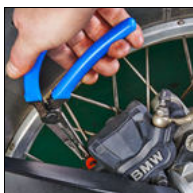

Part number	Description	
Packed in blister		
<b>BV.52284</b>	Multifunctional clamp	1

## RETRACTABLE CERAMIC CUTTER



The blade retract itself in the cutter, for an increased security.  
The ceramic blade lives 10 times longer than blades in steel.



Part number	Description	
Packed in a mini-display		
<b>BV.52187</b>	Retractable ceramic knife	9

Part number	Description	
Bulk		
<b>BV.52200</b>	2 ceramic blades to change	1

## SCRAPER WITH RETRACTABLE RAZOR BLADE



Easily remove window stickers, paint, glue, sealants or adhesives on glass, walls, floors or other smooth surfaces.  
The blade retracts for safety purposes.  
Blade storage in the handle.  
3 razor blades included.



Part number	Description	
Packed in a mini-display		
<b>BV.52003</b>	Razor scraper	12

Part number	Description	
Bulk		
<b>BV.11HA004-1</b>	10 replacement blades	1



## SCRAPER WITH INTERCHANGEABLE PLASTIC BLADE



Double-sided plastic blade.  
Ideal for removing decals and stickers from the windshield.  
May also be used with metal blades.

Part number	Description	
Per unit, with hanging tag		
<b>BV.52408</b>	Scraper with interchangeable plastic blade	1

## ENGRAVER WITH DIAMOND HEAD



Engraves on metal, plastic, wood, ceramic, glass, etc.  
Motor running at over 23000 rpm.  
The engraver operates for up to 5 hours.  
Industrial diamond bits (2 pieces of 2.35mm included)

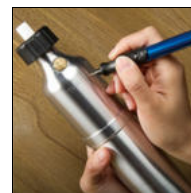

Part number	Description	Material	
Packed in a mini-display			
<b>BV.52144</b>	Battery-operated engraver	Aluminium	8
Part number	Description		
Bulk			
<b>BV.52171</b>	Replacement kit: 3 heads		1

## ANTI-SLIP BODYWORK COVER



Allows to work in the motor compartment in all liberty, without scratching the car.  
Anti-slip surface easily to clean.  
It has no magnet to avoid damaging the bodywork.

Part number	Description	
Packed in a small bag, with hanging notch		
<b>BV.52282</b>	Bodywork coverage (900x610x5mm)	1

## PROTECTION CARPET WITH LED LIGHTS



This tool has multiple functions:  
Allows to repair cars from beneath without using a light, to use it like a cushion for the head,  
to work beneath a sink,...  
2 ranges of 12 LED lamps  
Batteries not included: 3x LR6 1,2V batteries required.



Part number	Description	
Bulk		
<b>BV.52281</b>	Protection carpet (460x270x30mm)	1



UNIVERSAL BATTERY HOLDER

Battery holder with adjustable handle for an easy transport.



Part number	Description	
Bulk		
BV.52179	Battery holder (115-175mm)	1

TERMINAL AND BATTERY TERMINAL CLEANER

The upper brush cleans the wire terminals while the lower brush cleans the battery terminals.





Part number	Description	Material	
Bulk			
BV.52181	Cleaner with 2 brushes	Steel	1

PROFESSIONAL TOOL BOX 160 PCS

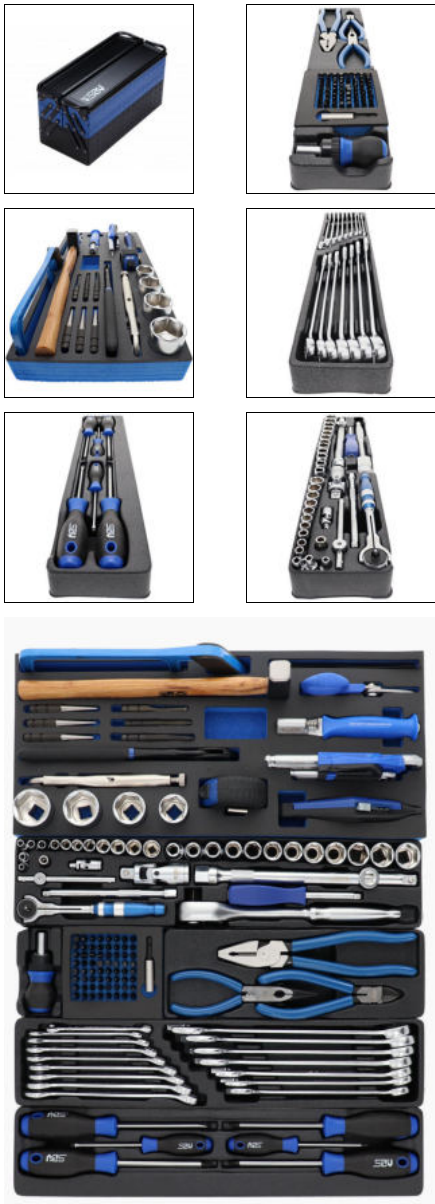

- Content:**
- Sockets:**
- 13 x Hexagon sockets 1/4" (CRV), Sizes: 4, 4.5, 5, 5.5, 6, 7, 8, 10, 11, 12, 13, 14 mm
  - 16 Sockets 1/2" (CRV), Sizes: 10, 11, 12, 13, 14, 15, 16, 17, 18, 19, 21, 22, 24, 27, 30, 32 mm;
  - Grooved finish for better grip
  - 4 x Hexagon sockets 1/2" (CRV), Sizes: 24, 27, 30, 32 mm
  - 1 x Sliding T-handle 1/4"
- Wrenches & ratchets:**
- 1 x Ratchet with swivel joint 1/2" 72-tooth (CRV & Aluminum)
  - 1 x Ratchet with swivel joint 1/4" 72-tooth (CRV & Aluminum)
  - 16 x Mixed keys (CRV), Sizes: 8, 9, 10, 11, 12, 13, 14, 15, 16, 17, 18, 19, 21, 22, 23 & 24mm
  - 9 x Long Hex Wrenches, Sizes: 1.5, 2, 2.5, 3, 4, 5, 6, 8, 10mm
- Extensions & cardans:**
- 2 x Extension 1/4" 50 & 100mm hexagonal head (CRV)
  - 2 x Extension 1/2" 125 & 250mm, hexagonal head (CRV)
  - 1 x Extension adapter 1/2"
  - 1 x Universal joint 1/2" (Cr-Mo)
  - 1 x Universal joint 1/4" (Cr-Mo)
- Bit holders:**
- 1 x Bit holder 1/4"
  - 1 x Bit holder
- Phosphate finished bits:**
- 7 x Phillips: PH0, PH1, PH2, PH2, PH2, PH2, PH3
  - 7 x PZ: PZ0, PZ1, PZ2, PZ2, PZ2, PZ2, PZ3
  - 11 x STAR (TORX): T6, T7, T8, T9, T10, T15, T20, T25, T27, T30, T40
  - 11 x TAMPERPROOF STAR (TORX): T6H, T7H, T8H, T9H, T10H, T15H, T20H, T25H, T27H, T30H, T40H
  - 9 x PLAT: 3, 4, 4, 4.5, 5.5, 5.5, 6.5, 6.5, 8mm
  - 11 x HEX: 2, 2.5, 3, 3, 4, 4, 5, 5, 6, 6, 8mm
  - 4 x SPLINE: M4, M5, M6, M8
  - 4 x RIBE: 4, 5, 6, 8
- Screwdrivers:**
- 1 x Mini screwdriver with ratchet bit holder
  - 1 x Square socket screwdriver 1/4" (CRV)
  - 1 x Flat screwdriver 3mm, 160mm, (hexagonal blade)
  - 1 x Flat screw driver 4mm, 215mm, (hexagonal blade)
  - 1 x Flat screwdriver 3mm, 160mm, (hexagonal blade)
  - 1 x Screwdriver PZ2, 215mm, (hexagonal blade)
  - 1 x Phillips screwdriver PH0, 160mm, (hexagonal blade)
  - 1 x Phillips screwdriver PH1, 215mm
  - 1 x Screwdriver PH2, 215mm, (hexagonal blade)
- Clamps:**
- 1 x Multi-socket clamp 250mm
  - 1 x Seal clamp 200mm
  - 1 x Long nose clamp 160mm
  - 1 x Universal clamp 250mm
  - 1 x Spring-loaded cutting pliers 160mm
- Various:**
- 1 x Hammer 300g
  - 6 x Chisels & drift punch: 12 & 15 mm chisels, 4 mm punch, conical punch, 2 drift punches
  - 1 x Interchangeable handle for chisel set & drift punch
  - 1 x Mini saw & 5 spare blades
  - 1 x Cutter with an ergonomic handle
  - 1 x Professional chisels
  - 1 x Tape measure (5m)



Part number	Description	
Packed in case		
BV.52392	Professional tool box 160pcs Weight: 15,2kg	1

MOTORBIKE TOOL KITS



Weight base kit: 2,5kg  
Content All motor bicycles:  
Wrenches & ratchets:  
10 x Keys MIT\*\*: Sizes 8 (5/16, E10), 10 (3/8, E12), 11 (7/16, E14), 12 (15/32, -), 13 (1/2, E16), 14 (9/16, E18), 16 (5/8, E20), 17 (11/32, -)  
1 x Ratchet 3/8", 72 teeth, pivotable head

Sockets:  
2 x Plug socket (14mm & 16mm), 3/8"  
8 x Socket MIT\*\*:  
1/4" Sizes: 6 (1/4, E8), 10 (3/8, E12), 12 (15/32, -)  
3/8" Sizes: 13 (1/2, E16), 15 (19/32, -), 17 (11/16, -), 18 (23/32, E22)  
3 x Sockets 3/8" (T45 & T50: 30mm; T55: 50mm)  
1 x Socket holder

Bits & bitsholder:  
10 x Bits 1/4" (2, 2.5, 3, 4, 5, 5.5, 6, 7, 8mm, PH2(30mm))  
10 x Bits 1/4" (T10, T15, T20, T25, T27, T30, T40, T45, T50, 5.5 flat (30mm))  
1 x Bitsholder 1/4" x 3/8", 25mm  
1 x Bitsholder 3/8" x 1/4", 30mm

Extensions & adapters:  
1 x Extension Poplock\* 3/8", 150mm  
1 x Extension with handle 1/4", 150mm  
1 x Adaptor

Various:  
1 x Expandable light 174 & 585mm, 2 magnets, 4 x LR44 included  
1 x Clamp 3-in-1, 165mm  
1 x Pressure tyre verifier  
1 x Wheel extractor 3/8", 17- 22/24 - 19mm, aluminum  
10 x Tie wraps  
1 x Cover in nylon ultra resistant

Content All BMW:  
The set 'All motor bicycles'  
1 x Key MIT: size 19  
1 x Coil extractor for BMW, 32 x 37mm, aluminum

Content BMW Pro & Touring:  
The set 'All motor bicycles'  
1 x Key MIT: Size 19  
1 x Coil extractor for BMW, 32 x 37mm, aluminum  
1 x Extension Turbo-Z Poplock  
1 x Socket 24 MIT 3/8  
1 x Key MIT: Size 21

Part number	Description	
Packed in a pouch		
BV.52301	All BMW 63 pcs	1
BV.52300	All motor bicycles 61 pcs	1
BV.52302	BMW-Pro & Touring	1



## ESSENTIAL MOTORBIKE TOOL KIT (54 PCS)

Professional tools, compact and light for minor adjustments on the road



Weight: 1,1kg

### Content:

#### Adaptors:

Douille 1/4" MIT - 14 mm (9/16, E18) Adaptor 1/4" M to 1/4" F  
Adaptor 13mm square socket holder 3/8" with locking système

#### Wrenches:

Mixed flat ratchet wrench 13mm with MIT ring side - 13mm (1/2, E16)  
Mixed wrench 8mm with MIT ring side - 8mm (5/16, E10)  
Mixed wrench 10mm with MIT ring side - 10mm (3/8, E12)  
Mixed wrench 12mm with MIT ring side - 12mm (15/32)  
Douille 1/4" MIT - 13 mm (1/2) Mixed wrench 114mm with MIT ring side - 14mm (9/16, E18)

#### Bits:

Bits 1/4" 25mm / 6,35 (T8, T10, T15, T20, T25, T27, T30, T40, T45, T50, T55, flat 5)  
Bits 1/4" 25mm / 6,35 (H1.5, H2, H2.5, H3, H4, H5, H5.5, H6, H7, H8, H10, PH2)

#### Sockets:

Socket 1/4" MIT - 6 mm (1/4, E8)  
Socket 1/4" MIT - 8 mm (5/16, E10)  
Socket 1/4" MIT - 10 mm (3/8, E12)  
Socket 1/4" MIT - 11mm (7/16, E14)  
Socket 1/4" MIT - 12 mm (15/32)  
Socket 1/4" MIT - 13 mm (1/2)  
Socket 1/4" MIT - 14 mm (9/16, E18)  
Spark plug 3/8", 14mm with 16mm HEX exterior  
Spark plug 3/8", 16mm with 16mm HEX exterior  
Socket support 7 x 1/4" and 2 x 3/8"

#### Various:

3-in-1 multifunctional tool (130mm): T-handle, bits holder ratchet 1/4" (+75Nm), ratchet of 11mm (+100Nm)  
Extension of 135mm bits holder 1/4" (automatic locking, aluminium Turbo rings)  
Manometer pencil for tires 0-3,5 bar and/or 0-50 psi  
Cutting pliers wrench with long nose 169mm  
Cable ties 100mm x 10 pcs  
Pouch in Teteron with double layer

Part number	Description	
Packed in a pouch		
<b>BV.52500</b>	Motorbike set 54 pcs (all brands)	1

## BASIC MOTORBIKE SET (60 PIECES) AND EXTENSION SLEEVE

Professional tools, compact and light for minor adjustments on the road



Weight: 1,1kg

**Basic set 54 pieces (BV.52500) + complementary tools:**

#### Wrenches:

Mixed wrench 16mm with MIT ring side - 16mm (5/8, E20)

#### Sockets:

Socket 1/4" MIT 15mm (19/32, -)  
Socket 1/4" MIT 17mm (11/16, -)  
Spark plug 3/8", 14mm with 16mm HEX exterior  
Spark plug 3/8", 16mm with 16mm HEX exterior

#### Various:

Extension 125mm 3/8" PopLock (automatic locking) with HEX 16mm exterior

Part number	Description	
Packed in a pouch		
<b>BV.52501</b>	Motorbike tool set 60 pcs (all brands)	1

Part number	Description	
Packed in a pouch		
<b>BV.52535</b>	Additional sleeve specific tools all brands	1
<b>BV.52532</b>	Additional sleeve specific BMW tools	1
<b>BV.52534</b>	Additional sleeve specific Triumph & Japanese brands tools	1
<b>BV.52533</b>	Additional sleeve specific KTM & Ducati tools	1



### MOTORBIKE SET SPECIFIC FOR BMW (70 PIECES)

Professional tools, compact and light for minor adjustments on the road



Weight: 2,5kg  
**Basic kit 60 pieces (BV.52501) + specific BMW sleeve includes:**  
**Adaptors:**  
3/8" adaptors - tire extractor HEX 17-22/24-19mm in Aluminium maximum torque 120Nm  
**Wrenches:**  
Mixed wrench 17mm with MIT ring side  
Mixed wrench 19mm with MIT ring side  
**Bits:**  
Bits T55 on socket 3/8" 50mm  
**Sockets:**  
Socket 3/8" MIT - 24mm (15/16, E30)  
**Various:**  
Ratchet 3/8" 72 teeth light and super resistant +250Nm  
BMW coil extractor very light in aluminium  
Pouch in nylon waterproof



Part number	Description	
Packed in a pouch		
BV.52502	Motorbike tool set 70 pcs (BMW)	1

### MOTORBIKE SET SPECIFIC FOR KTM & DUCATI (68 PIECES)

Professional tools, compact and light for minor adjustments on the road



Weight: 2,5kg  
**Basic kit 60 pieces (BV.52501) + specific KTM & Ducati sleeve includes:**  
**Wrenches:**  
Mixed wrench 17mm with MIT ring side  
**Sockets:**  
Socket 3/8" MIT - 22mm (7/8)  
Socket 3/8" MIT - 32mm (1-1/4)  
Socket 3/8" bit holder 1/4" with lock  
**Various:**  
Ratchet 3/8" 72 teeth light and super resistant +250Nm  
Enlarger 3/8" (F) to 1/2" (M) wit extra low profile  
Pouch in nylon waterproof



Part number	Description	
Packed in a pouch		
BV.52503	Motorbike tool set 68 pieces (KTM & Ducati)	1



## MOTORBIKE SET SPECIFIC FOR TRIUMPH, HONDA, KAWASAKI, SUZUKI & YAMAHA (70 PIÈCES)

Outils professionnels, compacts et légers pour toutes motos Triumph, Honda, Kawasaki, Suzuki & Yamaha



**Basic kit 60 pieces (BV.52501) + specific Triumph & Japanese brands sleeve includes:**

**Adaptateurs:**

3/8" adaptors - tire extractor HEX 17-22/24-19mm in Aluminium maximum torque 120Nm

**Wrenches:**

Mixed wrench 17mm with MIT ring side

**Sockets:**

Socket 3/8" HEX 14mm

Socket 3/8" MIT - 22mm (7/8)

Socket 3/8" MIT - 27mm (1-1/16)

Socket 3/8" bit holder 1/4" with lock

**Various:**

Ratchet 3/8" 72 teeth light and super resistant +250Nm

Enlarger 3/8" (F) to 1/2" (M) wit extra low profile

Pouch in nylon waterproof



Part number	Description	
Packed in a pouch		
<b>BV.52504</b>	Motorbike tool set 70 pcs (Triumph & Japanese brands)	1



## VERY COMPLETE MOTORBIKE TOOL SET (ALL BRANDS)(75 PIECES)

Professional tools, compact and light for all motorbikes



Weight: 2,9kg

**Basic kit 60 pieces (BV.52501) + sleeve with tools adaptable to all brands, includes:**

**Adaptors:**

3/8" adaptors - tire extractor HEX 17-22/24-19mm in Aluminium maximum torque 120Nm

**Wrenches:**

Mixed wrench 17mm with MIT ring side

Mixed wrench 19mm with MIT ring side

**Bits:**

Bits T55 on socket 3/8" 50m

**Sockets:**

Socket 3/8" HEX - 14mm

Socket 3/8" MIT - 22mm (7/8)

Socket 3/8" MIT - 24mm (15/16, E30)

Socket 3/8" MIT - 27mm (1-1/16)

Socket 3/8" MIT - 32mm (1-1/4)

Socket 3/8" bit holder 1/4" with lock

**Various:**

Ratchet 3/8" 72 teeth light and super resistant +250Nm

BMW coil extractor very light in aluminium

Enlarger 3/8" (F) to 1/2" (M) wit extra low profile

Pouch in nylon waterproof



Part number	Description	
Packed in a pouch		
<b>BV.52530</b>	Very complete motorbike tool set 75 pcs (all brands)	1



SUPPORT FOR MINI-DISPLAYS

Marking SBV Tools

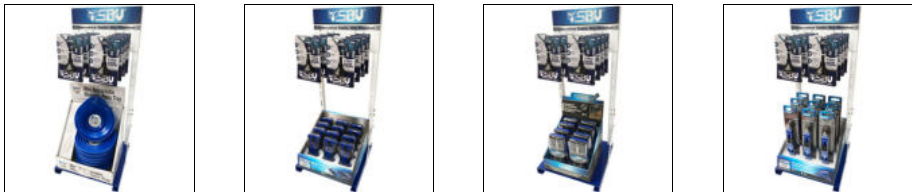

Part number	Description	
Bulk		
BV.52116	3 mini-displays or 2 mini-displays + 8 deburring tools 220x650x230mm	1

METALLIC DISPLAYS

Interchangeable marking: CASTEELS France / SBV Tools



Part number	Description	
Bulk		
ZY.1MLINE	Metal display stand with adjustable feet 2x 40 hooks (length: 15 & 18cm), with their label holders 1000x2070mm	1
ZY.4FMETAL	4 sides rotating display, on wheels 128 hooks (length: 10cm) 510x1760mm	1

**B**

BV.11HA004-1 .....	30
BV.11HA005 .....	12
BV.11HT001 .....	26
BV.11HT002 .....	4
BV.52003 .....	30
BV.52016 .....	9
BV.52017 .....	9
BV.52020 .....	24
BV.52021 .....	23
BV.52022 .....	23
BV.52023 .....	16
BV.52024 .....	16
BV.52025 .....	10
BV.52027 .....	10
BV.52028 .....	10
BV.52029 .....	10
BV.52030 .....	8
BV.52031 .....	8
BV.52032 .....	8
BV.52033 .....	13
BV.52035 .....	25
BV.52037 .....	11
BV.52038 .....	11
BV.52039 .....	10
BV.52040 .....	12
BV.52041 .....	27
BV.52044 .....	9
BV.52045 .....	9
BV.52046 .....	9
BV.52047 .....	19
BV.52049 .....	19
BV.52050 .....	19
BV.52051 .....	12
BV.52052 .....	12
BV.52053 .....	13
BV.52054 .....	11
BV.52055 .....	15
BV.52056 .....	5
BV.52057 .....	5
BV.52058 .....	21
BV.52059 .....	21
BV.52060 .....	21
BV.52061 .....	21
BV.52064 .....	17
BV.52065 .....	17
BV.52066 .....	17
BV.52097 .....	29
BV.52098 .....	26
BV.52099 .....	27
BV.52100 .....	13
BV.52101 .....	13
BV.52102 .....	14
BV.52103 .....	14
BV.52104 .....	14
BV.52116 .....	38
BV.52120 .....	20
BV.52121 .....	28
BV.52123 .....	26
BV.52125 .....	25
BV.52126 .....	14
BV.52127 .....	14
BV.52128 .....	14
BV.52129 .....	14
BV.52130 .....	8
BV.52131 .....	8
BV.52132 .....	18
BV.52134 .....	18
BV.52136 .....	18
BV.52138 .....	14
BV.52139 .....	14
BV.52140 .....	28
BV.52141 .....	20
BV.52142 .....	6
BV.52144 .....	31
BV.52145 .....	7
BV.52162 .....	9
BV.52163 .....	9
BV.52164 .....	9

**B**

BV.52165 .....	9
BV.52166 .....	29
BV.52167 .....	29
BV.52168 .....	28
BV.52169 .....	28
BV.52170 .....	20
BV.52171 .....	31
BV.52172 .....	7
BV.52176 .....	5
BV.52179 .....	32
BV.52181 .....	32
BV.52182 .....	16
BV.52183 .....	16
BV.52184 .....	15
BV.52185 .....	15
BV.52186 .....	22
BV.52187 .....	30
BV.52188 .....	4
BV.52189 .....	4
BV.52190 .....	4
BV.52191 .....	4
BV.52192 .....	7
BV.52193 .....	5
BV.52200 .....	30
BV.52202 .....	5
BV.52203 .....	7
BV.52231 .....	14
BV.52232 .....	14
BV.52233 .....	14
BV.52234 .....	14
BV.52235 .....	12
BV.52236 .....	12
BV.52237 .....	12
BV.52277 .....	4
BV.52278 .....	4
BV.52279 .....	28
BV.52281 .....	31
BV.52282 .....	31
BV.52284 .....	30
BV.52295 .....	6
BV.52296 .....	20
BV.52300 .....	34
BV.52301 .....	34
BV.52302 .....	34
BV.52303 .....	28
BV.52304 .....	28
BV.52392 .....	33
BV.52400 .....	21
BV.52401 .....	21
BV.52402 .....	26
BV.52403 .....	29
BV.52404 .....	24
BV.52405 .....	16
BV.52406 .....	15
BV.52407 .....	22
BV.52408 .....	31
BV.52409 .....	25
BV.52410 .....	27
BV.52412 .....	16
BV.52423 .....	28
BV.52500 .....	35
BV.52501 .....	35
BV.52502 .....	36
BV.52503 .....	36
BV.52504 .....	37
BV.52530 .....	37
BV.52532 .....	35
BV.52533 .....	35
BV.52534 .....	35
BV.52535 .....	35
<b>Z</b>	
ZY.1MLINE .....	38
ZY.4FMETAL .....	38

Lined area for notes.

**[WWW.CASTEELS.FR](http://WWW.CASTEELS.FR)**





**WWW.CASTEELS.FR**

**CASTEELS France sàrl**

ZA du Champ de Courses  
76560 Doudeville - FRANCE

**EXPORT EUROPE & USA**

 +32 (0)2 648 35 17

 +32 (0)2 648 65 95

 [info@casteels.fr](mailto:info@casteels.fr)

**FRANCE & DOM/TOM**

 +33 (0)2 32 70 64 02

 +33 (0)2 32 70 64 20

 [contact@casteels.fr](mailto:contact@casteels.fr)